

Inline Check Valves

CG Series Gas & Cryogenic Check Valves

Application

Inline check valves with metal seat option for cryogenic service or with soft seat option for leak-free operation in gas service.

Features

- ✓ One directional flow indicated by arrow on body.
- ✓ Large Cv for high flow capability and low pressure drop.
- ✓ Working temperature range:
320° F to +165° F for metal seats.
20° F to +165° F for soft seats.
- ✓ 1 psig opening pressure.
- ✓ Cleaned for use in oxygen service per CGA G-4.1

Materials

Body (B and BL suffix) ASTM B16 Brass
 Body (SS and SSL suffix) 203 Stainless Steel
 Spring Stainless Steel
 Piston..... Stainless Steel
 O-Ring (soft seat option units only) Viton
 Metal Seat 303 Stainless Steel

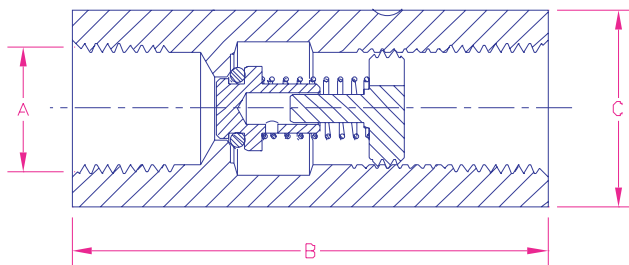

Soft Seat Option

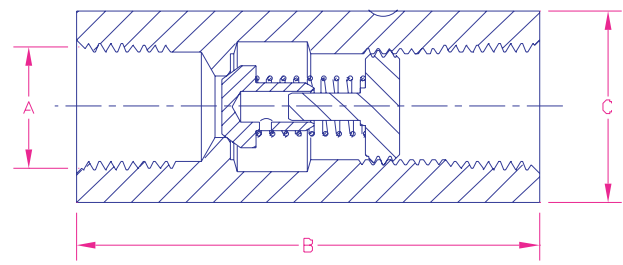

Metal Seat Option

Part Number	Seating Option	Inlet/Outlet Connections FNPT A	Length B	Wrenching Hex Size C	Cv	Maximum Operating Pressure
Stainless Steel Check Valves						
CG250SS	Metal	1/4"	2 ³ / ₈ "	1 ³ / ₁₆ "	.87	2000 PSIG
CG375SS	Metal	3/8"	2 ¹ / ₂ "	1"	2.3	2000 PSIG
CG500SS	Metal	1/2"	3"	1 ¹ / ₈ "	3.5	2000 PSIG
CG750SS	Metal	3/4"	3 ³ / ₈ "	1 ¹ / ₂ "	5.2	2000 PSIG
CG250SSL	Soft	1/4"	2 ³ / ₈ "	1 ³ / ₁₆ "	.87	250 PSIG
CG375SSL	Soft	3/8"	2 ¹ / ₂ "	1"	2.3	250 PSIG
CG500SSL	Soft	1/2"	3"	1 ¹ / ₈ "	3.5	2000 PSIG
CG750SSL	Soft	3/4"	3 ³ / ₈ "	1 ¹ / ₂ "	5.2	2000 PSIG
Brass Body Check Valves						
CG250B	Metal	1/4"	2 ³ / ₈ "	1 ³ / ₁₆ "	.87	2000 PSIG
CG375B	Metal	3/8"	2 ¹ / ₂ "	1"	2.3	2000 PSIG
CG500B	Metal	1/2"	3"	1 ¹ / ₈ "	3.5	2000 PSIG
CG750B	Metal	3/4"	3 ³ / ₈ "	1 ¹ / ₂ "	5.2	2000 PSIG
CG250BL	Soft	1/4"	2 ³ / ₈ "	1 ³ / ₁₆ "	.87	250 PSIG
CG375BL	Soft	3/8"	2 ¹ / ₂ "	1"	2.3	250 PSIG
CG500BL	Soft	1/2"	3"	1 ¹ / ₈ "	3.5	2000 PSIG
CG750BL	Soft	3/4"	3 ³ / ₈ "	1 ¹ / ₂ "	5.2	2000 PSIG