

Industrial Gas Valves

1206A Series

Packed Wrench-Operated Valves for Anhydrous Ammonia Applications

- ✓ One-piece lead carbon steel, case-hardened, nickel-plated stem
- ✓ Positive shut-off in corrosive gas service, exceptional durability
- ✓ One-piece PTFE packing = easy operation, durable & leak-resistant stem seal
- ✓ Designed to ensure a safe, long, trouble-free life under all service conditions
- ✓ Meets CGA standards
- ✓ 1206AX5 compatible with both CGA 705 and 240 outlets
- ✓ 1206AX9 compatible with CGA 240 outlet only
- ✓ Inlet Tap $\frac{1}{4}$ "-18 NPT

| | <u>English</u> | <u>Metric</u> |
|--------------------------|-----------------------------|-------------------------------|
| Maximum Working Pressure | 3000 PSI | 207 Bar |
| Burst Pressure | 15,000 PSI | 1034 Bar |
| Leak Rate | 1×10^{-5} atm cc/s | 1×10^{-5} Bar mL/sec |
| Operating Temperature | -50° F → +130° F | -45° C → +54° C |
| Operating Torque Closing | 5-6.5 ft.-lbs. | 6.8-8.8 N-m |
| Torque | 15 ft.-lbs. | 20.3 N-m |
| Cv Flow Factor | 0.733 | 0.733 |
| Cycle Life | 1000 Minimum | 1000 Minimum |

| | | |
|---------|---|-----------------|
| 1206AX5 | Packed Ammonia Cylinder Valve | 705, 240 Outlet |
| 1206AX9 | Packed Ammonia Cylinder Valve + Lead Washer | 240 Outlet |
| 628X1 | Recess Ammonia Yoke | 845 Outlet |
| 5877 | Adapter | 845 Outlet |

| | |
|-----------|--|
| CGA V-9 | Standards for Gas Cylinder Valves |
| CGA S1.1 | Standards for Pressure Relief Devices |
| CGA V-1 | Compressed Gas Cylinder Valve Outlet |
| A-A-59860 | US General Services Administration Standards for Gas Cylinder Valves |

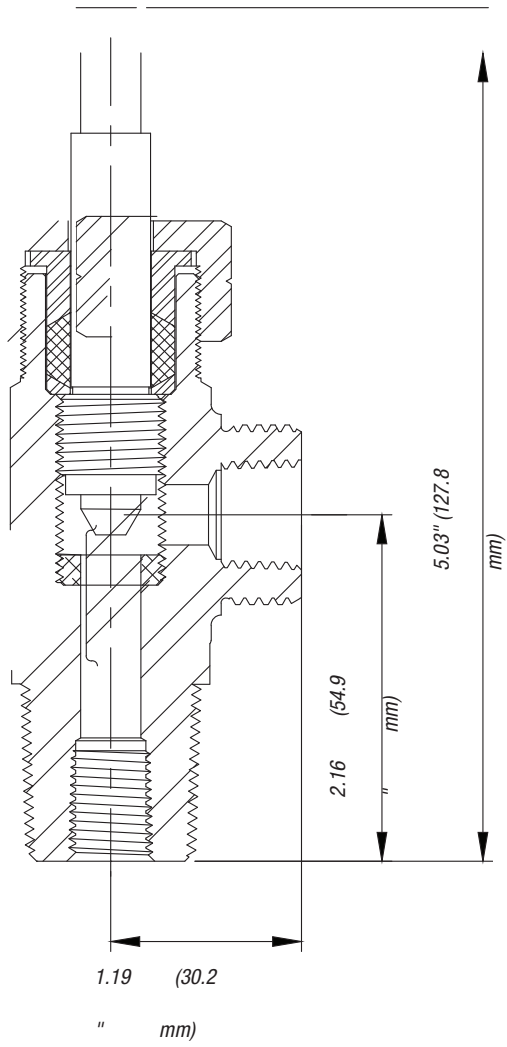

1206AX5

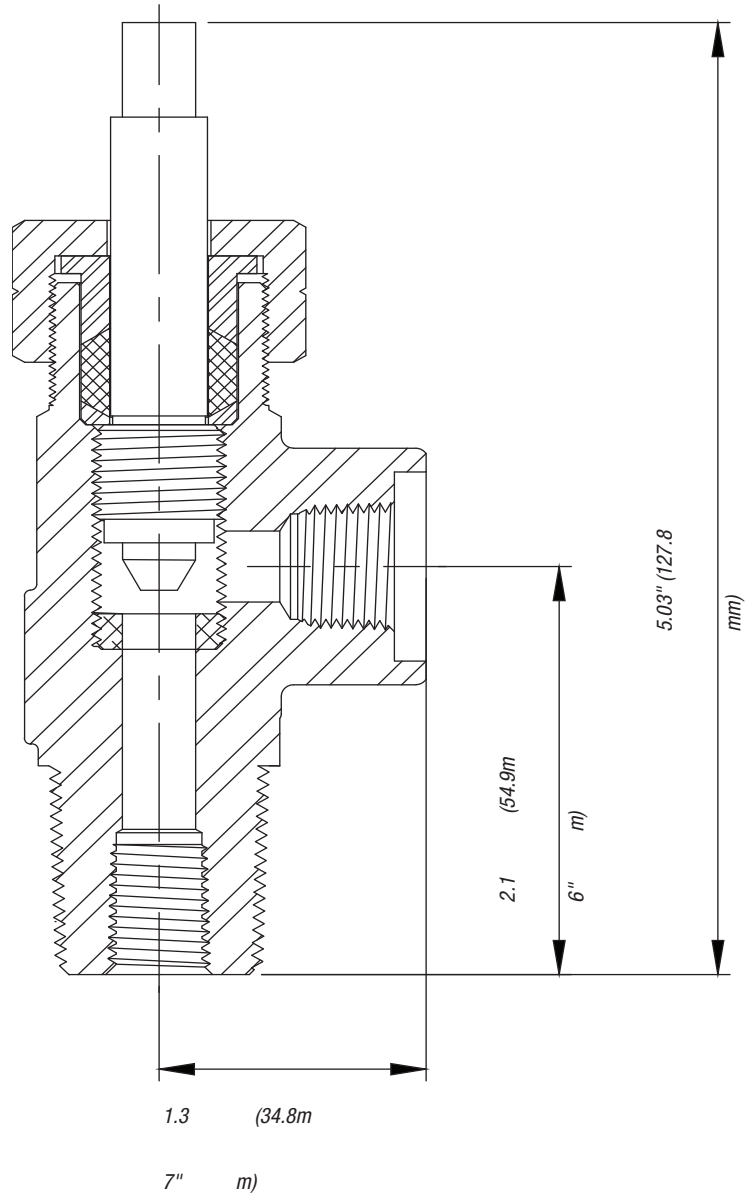

1206AX9